

nominal voltage	1.2 V
max. charge voltage	1.5 V
capacity	
nominal	2500mAh
minimal	>2300 mAh
typical	2300mAh
max. discharge current	30A
charge	
standard charge	charge current 250 mA
quick charge	2500 mA
recommended charge	-dV
termination control	dT/dt
parameters	TCO
trickle charge current	72...125 mA
continuous overcharge (less than 1 year)	<250 mA
internal resistance	Average 6 mOhms (4~8mOhms)
life expectancy	>500 cycles
Charge retention	>1750mAh
ambient temperature range	0...45°C 10...45°C -20...50°C -10...45°C -10...35°C

conditions

at standard charge (0.1C/20°C)
 discharge at 0.2C
 discharge at 30A
 discharge at 30A
 0.8V end discharge voltage
 ambient temperature 20°C
 ambient temperature 20...50°C
 charge time 15hrs at 20°C
 1.05hrs for empty battery
 0...5 mV
 0.8...1°C per min
 40...45°C
 (recommended)

no conspicuous deformation
 no leakage

at 1000Hz
 battery fully charged

IEC61951-2 standard

discharge at 0.2C after storage
 28 days at 20+/-5°C
 standard charge
 fast charge
 discharge
 storage less than 3 months
 storage less than 1 year

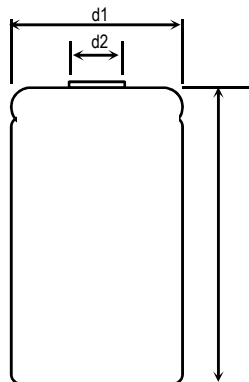
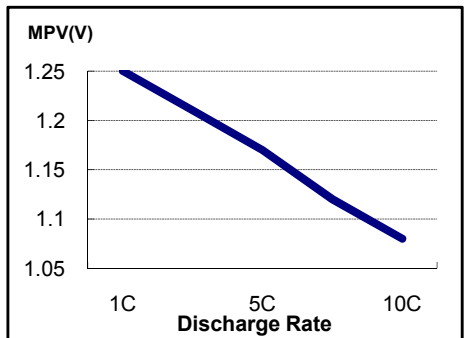
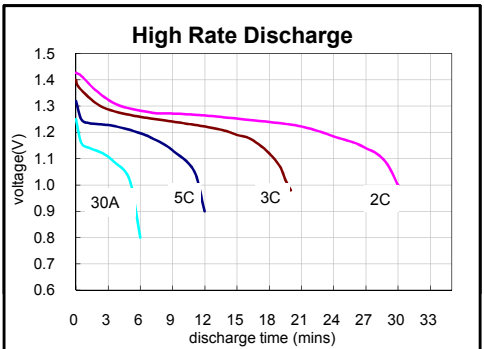
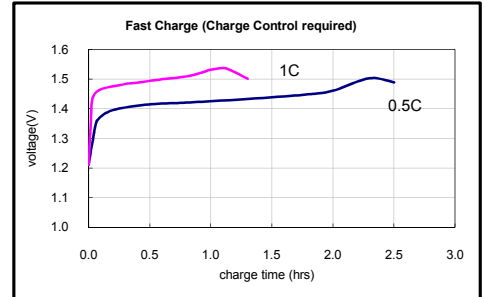
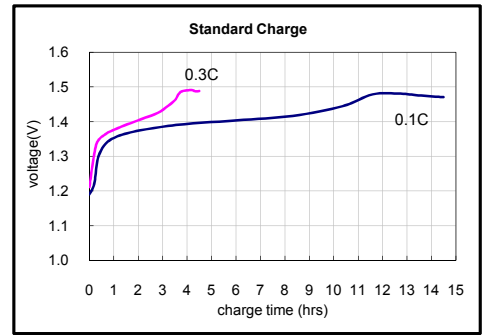

mechanical specifications

cell dimensions (with sleeve)	
diameter d1	23.0-0.5 mm
diameter d2	9.1+/-0.5 mm
height h1	44-0.5 mm
weight	approx. 55 g

DATA SHEET FOR	Ni-MH SC 2500mAh
VAPEXTECH DRAWING	VP2500SC
DRAWN BY / DATE	2010/2/20

Manufacturer reserves the right to alter or amend the design, model and specification without prior notice.